

# E-PC01

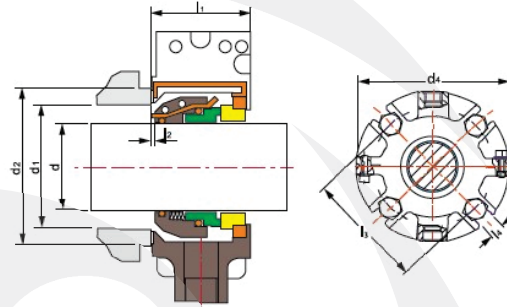
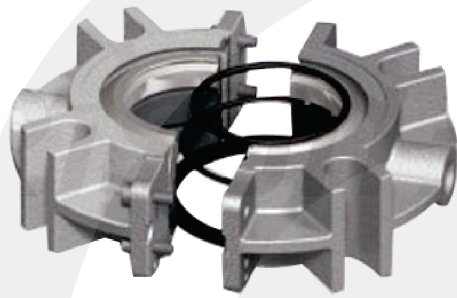

**Limites operacionais:**

Pressão < 1MPa  
 Velocidade < 3600rpm  
 Temperatura: +200°C

**Operating limits:**

Pressure < 1MPa  
 Speed < 3600rpm  
 Temperature: +200°C

- Anel Giratório (Carvão/SiC/TC)
- Anel Estacionário (Cerâmica/SiC/TC)
- Selo Secundário (VITON/NBR/EPDM)
- Mola & Outras Peças (SUS304/SUS316)
  
- Rotary Ring (Carbon/SiC/TC)
- Stationary Ring (Ceramic/SiC/TC)
- Secondary Seal (VITON/NBR/EPDM)
- Spring & Other Parts(SUS304/SUS316)

d (inches)	l <sub>1</sub>	l <sub>3</sub>						d <sub>4</sub>	l <sub>2</sub>	d <sub>2</sub>	d <sub>1</sub>		
		3/8	2/1	5/8	3/4	7/8	Nom				max	l <sub>4</sub>	
1.500	2.00	3.38	3.50	\	\	\	5.00	1/16	2.75	2.25	2.50	0.56	
1.625	2.00	3.50	3.63	\	\	\	5.00	1/16	2.88	2.38	2.63	0.56	
1.688	2.00	3.63	3.75	\	\	\	5.00	1/16	3.00	2.50	2.75	0.56	
1.750	2.00	3.63	3.75	\	\	\	5.00	1/16	3.00	2.50	2.75	0.56	
1.875	2.00	3.75	3.88	\	\	\	5.00	1/16	3.13	2.63	2.88	0.56	
1.937	2.00	3.94	4.06	\	\	\	5.00	1/16	3.25	2.75	3.00	0.56	
2.000	2.00	3.94	4.06	\	\	\	5.00	1/16	3.25	2.75	3.00	0.56	
2.125	2.00	4.06	4.19	4.32	\	\	6.00	1/16	3.38	2.88	3.13	0.69	
2.250	2.00	4.19	4.32	4.44	\	\	6.25	1/16	3.50	3.00	3.25	0.69	
2.375	2.00	4.50	4.62	4.75	\	\	6.50	1/16	3.63	3.13	3.38	0.69	
2.437	2.00	4.57	4.70	4.82	\	\	6.50	1/16	4.00	3.25	3.75	0.69	
2.500	2.00	4.57	4.70	4.82	\	\	6.50	1/16	4.00	3.25	3.75	0.69	
2.750	2.50	\	5.56	5.68	\	\	7.75	1/8	4.75	3.75	4.25	0.69	
3.000	2.50	\	5.82	5.95	\	\	8.00	1/8	5.00	4.00	4.50	0.72	
3.250	2.50	\	6.13	6.25	\	\	8.25	1/8	5.25	4.25	4.75	0.72	
3.500	2.50	\	4.32	6.45	6.57	\	8.50	1/8	5.50	4.50	5.00	0.81	
3.750	2.50	\	4.50	6.63	6.75	\	8.75	1/8	5.75	4.75	5.25	0.81	
4.000	2.50	\	6.82	6.95	7.07	\	9.00	1/8	6.00	5.00	5.50	0.81	
4.250	2.50	\	7.00	7.13	7.25	\	9.25	1/8	6.25	5.25	5.75	0.81	
4.500	2.50	\	7.25	7.38	7.50	\	9.50	1/8	6.50	5.50	6.00	0.81	
4.750	2.50	\	7.50	7.63	7.75	\	9.75	1/8	6.75	5.75	6.25	0.81	
5.000	3.75	\	\	8.32	8.45	8.57	11.00	1/8	7.50	6.25	7.00	0.94	
5.500	3.75	\	\	8.82	8.95	9.07	11.50	1/8	8.00	6.75	7.50	0.94	
6.000	3.75	\	\	9.32	9.45	9.57	12.00	1/8	8.50	7.25	8.00	0.94	
6.500	3.75	\	\	9.82	9.95	10.07	12.50	1/8	9.00	7.75	8.50	0.94	
7.000	3.75	\	\	10.32	10.45	10.57	13.00	1/8	9.50	8.25	9.00	0.94	
7.250	3.75	\	\	10.57	10.70	10.82	13.25	1/8	9.75	8.50	9.25	0.94	
7.500	3.75	\	\	10.82	10.95	11.07	13.50	1/8	10.00	8.75	9.50	0.94	
7.750	3.75	\	\	11.07	11.20	11.32	13.75	1/8	10.25	9.00	9.75	0.94	

d (mm)	l <sub>1</sub>	l <sub>3</sub>								d <sub>4</sub>	l <sub>2</sub>	d <sub>2</sub>	d <sub>1</sub>		
		10	12	14	16	18	20	22	Nom				max	l <sub>4</sub>	
38	51	67	89	\	\	\	\	\	127	1.5	70	57	63	14.2	
40	51	90	92	\	\	\	\	\	127	1.5	73	60	67	14.2	
45	51	93	95	\	\	\	\	\	140	1.5	76	63	70	14.2	
50	51	101	103	\	\	\	\	\	140	1.5	83	70	76	14.2	
55	51	107	109	111	113	\	\	\	159	1.5	89	76	83	17.5	
60	51	115	117	119	121	\	\	\	165	1.5	92	80	86	17.5	
65	51	117	119	121	123	\	\	\	165	1.5	102*	83	95*	17.5	
70	64	\	141	143	145	\	\	\	197	3.0	121	95	108	17.5	
75	64	\	147	149	151	\	\	\	203	3.0	127	102	114	18.3	
80	64	\	155	157	159	\	\	\	210	3.0	134	108	121	18.3	
85	64	\	160	162	164	166	168	\	216	3.0	140	114	127	20.6	
90	64	\	160	162	164	166	168	\	216	3.0	140	114	127	20.6	
100	64	\	173	175	177	179	181	\	229	3.0	153	127	140	20.6	
110	64	\	184	186	188	190	192	\	242	3.0	165	140	152	20.6	
180	96	\	\	\	\	271	273	275	337	3.0	248	216	235	23.8	
185	96	\	\	\	\	277	279	281	343	3.0	254	223	242	23.8	
190	96	\	\	\	\	277	279	281	343	3.0	254	223	242	23.8	
195	96	\	\	\	\	284	286	288	350	3.0	261	229	248	23.8	