

E-CS

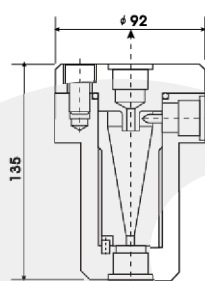

CS01

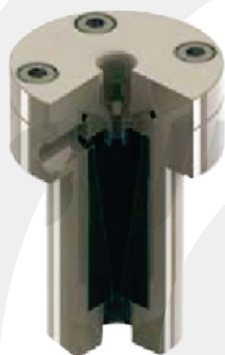
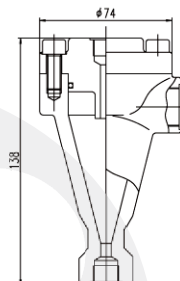

CS02

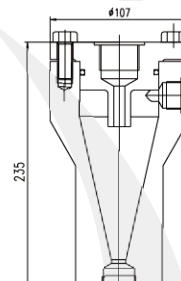

CS03

Operating Limits
Pressão: 6.4MPa
Temperatura de Trabalho: 125°
Batida: 1/2NPT
Material: Aço Inoxidável/Cerâmica
Planos de Operação: API 41.

Operating Limits
Pressure: 6.4MPa
Working Temperature: 125°
Nozzle: 1/2NPT
Material: Stainless steel/Ceramic
Operating plans: API 41.

Technical data	Cs01	Cs02	Cs03
Operating pressure max..(bar)	64	64	200
Operating temperature max..(°C)	125(60*)	125	150
Connections	G/NPT1/2	G/NPT1/2	G/NPT3/4,1
Weight approx.(kg)	3,5	2,0	8,0
Materials:casing/cover	316/304	316/304	316/304
O-ring	Viton	Viton	Viton