

# E-AB04

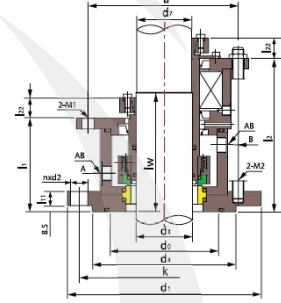
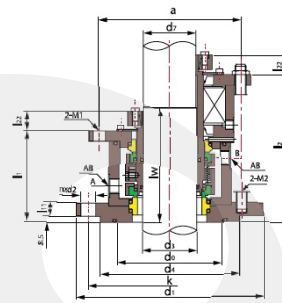

**Limites operacionais:**

Pressão < 0.6MPa/< 1.6MPa  
 Velocidade < 2m/s/<5m/s  
 Temperatura: -30°C~+200°C /-80°C~+250°C

**Operating limits:**

Pressure < 0.6MPa/< 1.6MPa  
 Speed < 2m/s/<5m/s  
 Temperature: -30°C~+200°C /-80°C~+250°C

- Anel Giratório (SiC/Carvão/TC)
- Anel Estacionário (SiC/TC/Cerâmica)
- Selo Secundário (VITON/Anel Encapsulado/PTFE)
- Outras Peças (SUS304/SUS316/Titânio/Hastelloy-C)

- Rotary Ring (SiC/Carbon/TC)
- Stationary Ring (SiC/TC/Ceramic)
- Secondary Seal (VITON/ Encapsulated Ring/PTFE)
- Other Parts(SUS304/SUS316/Titanium/Hastelloy-C)

**EGEMAF**  
 COMPONENTES ELETROMECÂNICOS LTDA.  
 Certificada ISO 9001/2008

$d_3^1$ (mm)	$d_7^1$	$d_1$	$nxd_2$	$d_4$	$d_0$	$k$	$l_1$	$l_2$	$lw^2$	$l_{11}$	$l_{22}$	$a$	$M_1$	$M_2$	A,B
40	38	175	4x18	110	90	145	110.5	159.5	143	15	28	122	M12	M16	G3/8
50	48	240	8x18	176	135	210	114.5	174.5	148	17	28	157	M12	M16	G3/8
60	58	240	8x18	176	135	210	119.0	181.5	158	17	28	168	M12	M16	G3/8
80	78	275	8x22	204	155	240	133.0	217.5	168	20	34	203	M16	M20	G1/2
100	98	305	8x22	234	190	270	137.5	218.5	178	20	34	228	M16	M20	G1/2
125	120	330	8x22	260	215	295	138.5	233.5	203	20	40	268	M20	M20	G1/2
140	135	395	12x22	313	250	350	152.5	250.5	208	20	40	285	M20	M20	G1/2
160	150	395	12x22	313	265	350	161.0	253.0	213	25	40	297	M20	M20	G1/2
180	170	445	12x22	364	310	400	166.0	263.5	233	25	45	332	M24	M20	G1/2
200	190	445	12x22	364	310	400	171.0	271.0	243	25	45	352	M24	M20	G1/2
220	210	505	16x22	422	340	460	\	\	263	25	\	\	M24	M20	G1/2